

### Step1



Remove the angle-connection "easy clic" from the bar rinser by turning it to the left.

### Step2



Insert a slotted screwdriver into the opening.

### Step3

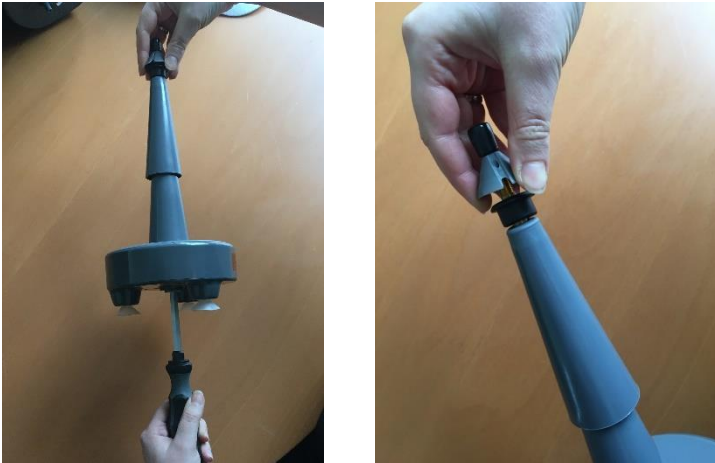

Hold the nozzle cap tight and use the slotted screwdriver to turn the valve stem off the nozzle cap.

### Step4



Push the new attachment onto the valve stem. Hold the valve rod firmly with the slotted screwdriver and turn the attachment onto the valve rod until it stops.

### Step1



Remove the angle-connection "easy clic" from the bar rinser by turning it to the left.

### Step2



Insert a slotted screwdriver into the opening.

### Step3

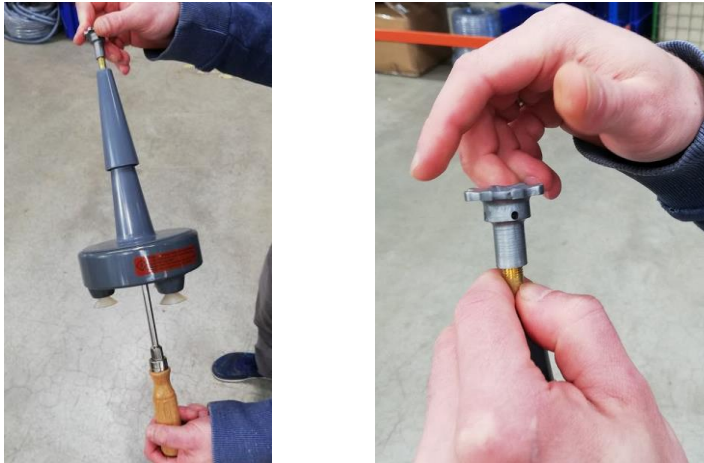

Hold the star bit tight and use the slotted screwdriver to turn the valve tube off the star bit.

### Step4



Push the new star bit onto the valve tube. Hold the valve tube firmly with the slotted screwdriver and turn the attachment onto the valve tube until it stops. For the star bits please use a 75.5 mm long distance holder in the glass protection.